

DETAIL SHOWN NOT TO SCALE

### MOUNTING DETAILS

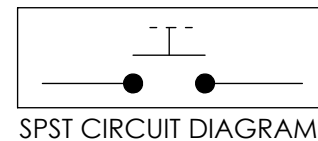
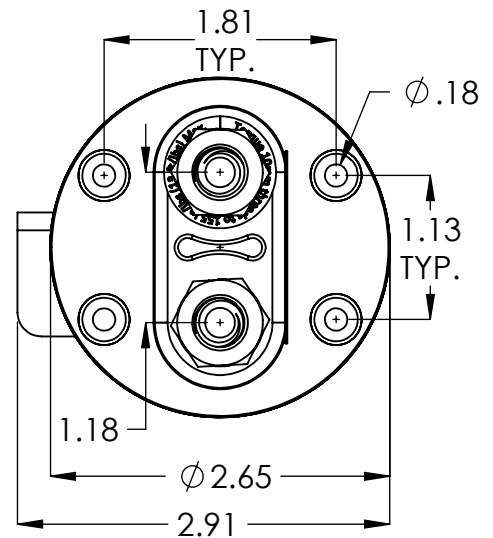
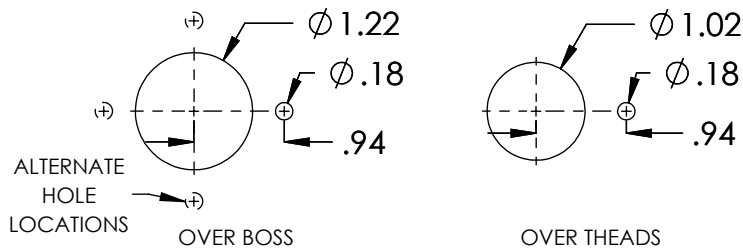

### Technical data:

Handle Material:	Red GF Nylon 6
Upper Housing Material:	Zinc Diecast
Lower Housing Material:	GP Phenolic
Min. Insulation Resistance:	100 Mohm
Dielectric Withstanding Voltage:	1,100V -1min
Voltage Drop Max.:	0.175 mV
Voltage:	48 VDC
Continuous Rating:	300 A
Overload:	750 A - 180sec. 1,500 A - 30sec.
Sealing:	IP67
Vibration:	4G / 50-2KHz
Shock:	6G / 11ms
Temperature Range:	-40C to +85C
Terminal Torque:	155 in.lb
Mounting Torque:	18 ft.lb

REV.	DESCRIPTION	DATE	APP'D
C	TORQUE TAG, UPDATE SPEC	4-5-19	RMF
B	16002-129 WAS 183224-007	4-26-17	RMF
A	ORIGINAL RELEASE	4-15-15	RMF

### PROPRIETARY AND CONFIDENTIAL

This document contains proprietary data for products designed by Shallco, Inc., of Smithfield, NC. No disclosure; reproduction, or use of any part thereof may be made except by written permission.

	NAME	DATE
DRAWN	JRT	4-15-15
CHECKED		
ENG APPR.	RMF	4-15-15
MFG APPR.		
Q.A.		

DIMENSIONS ARE IN INCHES  
TOLERANCES:  
FRACTIONAL  $\pm 1/32$   
ANGULAR: MACH  $\pm$  BEND  $\pm$   
TWO PLACE DECIMAL  $\pm .015$   
THREE PLACE DECIMAL  $\pm .005$

**SHALLCO**  
308 COMPONENTS DRIVE, SMITHFIELD, NC 27577 USA  
DO NOT SCALE DRAWING

TITLE: **LOCKOUT BATTERY DISCONNECT 48VDC-300AMPS**

BLANK WEIGHT: - PART WEIGHT: 0.8 LBS

SIZE **A** DWG. NO. **500DL-300** SHEET 1 OF 1 REV. **C**

SCALE: 1:2 FILENAME: 500DL-300

DWG NO: 500DL-300