



## The Horizon 642VES

starts with the world's best selling Horizontal clinical centrifuge and adds the versatility necessary to process specimen ranging from **serum, plasma, PPP, PRP, urine**, and more.

### OVERVIEW: THE FLEXIBILITY YOU NEED FOR ALL YOUR SAMPLE TYPES

The Model 642VES provides the flexibility labs need for a wide variety of specimen types. Providing g-forces as low as 250xg for Platelet Rich Plasma or as high as 2,000xg for Platelet Poor Plasma, the 642VES provides the performance that clinical laboratories require. Programmable force and time settings are simple to use; a digital readout clearly displays the RPM and Time settings.

Using patented technologies, the 642VES reduces blood separation processing times by 33% or more while minimizing use of valuable counter space. The performance of the 642VES maximizes sample integrity by keeping your patient samples cool during centrifugation, providing high quality gel separation layers, and minimizing the presence of cells or fibrin strands in the serum or plasma. The universal power supply and global safety approvals allow the 642VES to meet your global needs.

#### FEATURES

- **Electronic Timer w/ Display:** Scrollable time selection from 1 to 99 minutes
- **Capacity:** Qty (6) tubes from micro tubes (.5mL) up to 17mm x 100 mm (10mL)
- **Brushless AC Motor:** Smooth and quiet operation with no routine maintenance
- **Quiet Operation:** Double-encased motor assures quiet performance and low imbalance vibration
- **Cool Operating Temperature:** Unique design of the motor housing and rotation chamber allows for cool operation even under the heaviest work loads
- **Footprint:** Compact design uses less than 1 sq. ft. of counter space

#### SAFETY

- **Automatic Lid Lock:** Centrifuge will not run with the lid open, and the lid cannot be opened while samples are spinning
- **Positive Lid Latching:** Firm mechanical latching of the lid prevents the escape of debris in case of tube breakage
- **Clear Lid:** Offers safe observation and access for phototachometer
- **Regulatory Approvals:** Certified to US, Canadian, and European Safety standards.
- **Reinforced Guard Bowl:** Provides maximum safety and durability

#### APPLICATIONS

- Chemistry
- PPP
- Urine sedimentation
- Coagulation
- PRP
- General Purpose

## 642VES CENTRIFUGE FEATURES

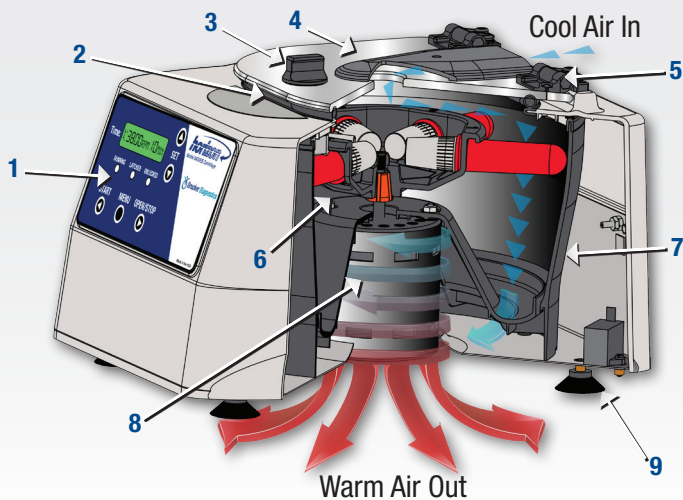

- 1..... Control Panel (see below)
- 2..... Lid Safety Interlock System
- 3..... Locking Knob
- 4..... Shatter Proof Lid
- 5..... Stay-In-Place Hinges
- 6..... Horizontal Rotor
- 7..... Composite Side Walls
- 8..... Brushless AC Motor
- 9..... Isolation Feet

## 642VES CENTRIFUGE CONTROL PANEL

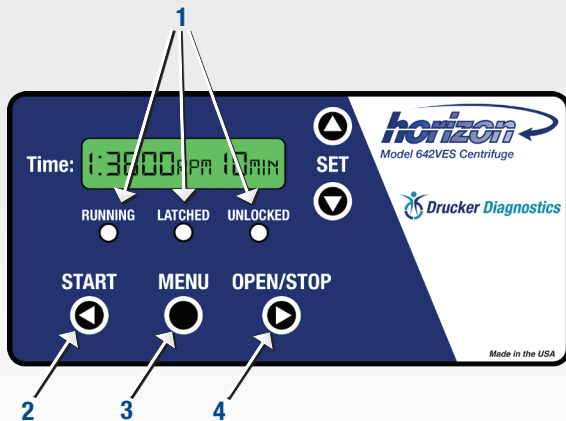

- 1..... Indicator Lights
- 2..... Blood Run Button
- 3..... Open/Stop Button
- 4..... Urine Start Button

## 642VES CENTRIFUGE SPECIFICATIONS

### Electrical

Voltage.....	120/220 (± 10/25 Volts)
Frequency.....	50/60 Hz
Max. Power Requirements .....	165 Watts
Protection Breaker .....	4 Amp. Re-settable
Centrifuge Motor .....	1/30 H.P. Brushless AC

### General

Overall Dimensions .....	Height.....	8.75 in. (22 cm)
	Width.....	11.75 in. (30 cm)
	Depth.....	14 in. (35.5 cm)
Weight .....		12 lbs. (5.4 kg)
Max. Acceleration Time .....		18 seconds
Max. Deceleration Time.....		20 seconds
Timer .....		Electronic, 1 to 30 minutes, preset to 10 minutes

**Speed** ..... 1,000 - 3,800 RPM

**Force** ..... 150 - 2,000 xg

### Warranty

The Drucker Diagnostics warranties that this centrifuge is free from defects in workmanship and parts for 2 years.

### 2-Stage Horizontal Rotor

Loading Angle

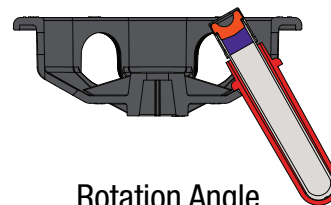

Rotation Angle

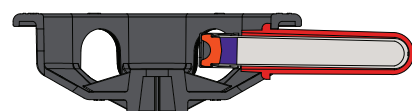

# 642VES CENTRIFUGE ROTOR & ACCESSORIES

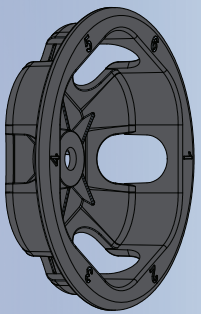

**6 Place Horizontal Rotor**  
p/n 7786067  
(Included)

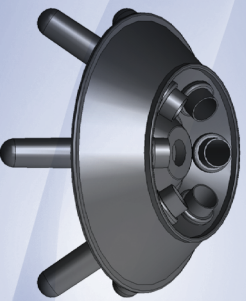





**6 Place Fixed-Angel Rotor**  
p/n 7786047  
(Optional)



**SmartView™ Platform**  
p/n 00-079-009-001  
(Optional)



Included with each centrifuge

	QTY Included	Part Number	Comments
	6	7713079	For use with 75 - 100 mm tubes (3 mL - 10 mL)
	2	7713064	For use with 13 x 75 mm tubes
	2	7713066	For use with 13 x 100 mm tubes
	2	7713068	For use with tubes up to 1 mL
	2	7713065	For use with tubes between 1.5 mL and 2 mL

Included with Fixed Angle Rotor

	2	7713032	For use with 17 x 125 mm tubes
-----------------------------------------------------------------------------------	---	---------	--------------------------------





Optional Accessories

	Available as an accessory	9150	For use with glass vials or tubes
	Available as an accessory	1525	For use with glass vials or tubes
	Available as an accessory	00-079-009-001	For use with the 6 series centrifuges.

# RECOMMENDED CENTRIFUGE SETTINGS

## FOR MODEL 642VES

Based on manufacturer's instruction's for use

APPLICATION		RPM	TIME	G-FORCE
	Urine Sedimentation	1,800 RPM	5	450 xg
	Vacutainer® SST & PST with gel	3,000 RPM	10	1,300 xg
	Vacutainer® Citrate Coagulation	3,300 RPM	15	1,500 xg
	Vacurette® SST & PST with gel	3,600 RPM	10	1,800 xg
	Vacurette® Citrate Coagulation	3,600 RPM	10	1,800 xg

### Alternate STAT Settings\*

APPLICATION	RPM	TIME	G-FORCE
All brands SST	3,800 RPM	7	2,000 xg
All brands PST	3,800 RPM	8	2,000 xg
All brands Coag	3,800 RPM	10	2,000 xg

\* Alternate centrifugation setting should be validated by the laboratory

Vacutainer is a registered trademark of Becton Dickinson

Vacurette is a registered trademark of Greiner Bio-One

Protected by U.S. Patents #6,811,531 & #D718463

Other Patents Pending

 Made in the U.S.A.

NOTE: Specifications subject to change.

 **Drucker Diagnostics**  
Innovative Solutions for a Healthier World

168 Bradford Drive, Port Matilda, PA 16870 U.S.A.

+1-814-692-7661 • Fax: +1-814-692-7662

www.druckerdiagnostics.com

Form No. 773 Rev. A