

horizon

PERFORMANCE SERIES

PLASMAFUGE-6

Model 842VES



FAST
Plasma Preparations
Platelet-Rich Plasma to
Platelet Poor / Free Plasma!

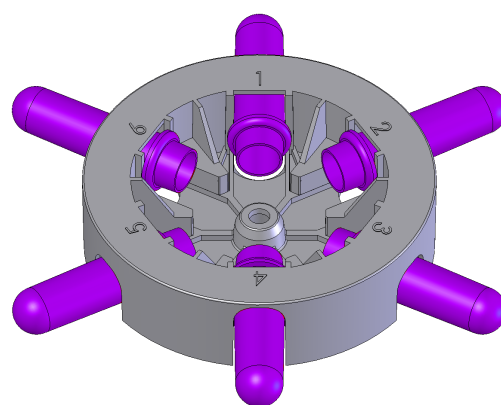

Horizontal Rotor
(standard)

- Rapid Separations
- Full Horizontal Separation for Six (6) Tubes up to 10ml
- Precise Variable Controls
- ETL Compliant to ANSI/UL Standards; CE Marked

SPECIFICATIONS:

General Specifications: Plasmafuge-6, Model 842VES Centrifuge

Overall Dimensions:	Height:	8.0 in. (20 cm)
	Width:	11.0 in. (28 cm)
	Depth:	13.5 in. (34 cm)
Min. Acceleration Time:		15 seconds
Min. Deceleration Time:		15 seconds
Weight:		23 lbs. (10.5 kg)
Centrifuge Motor:		1/2 H.P. Brushless DC
Protection Breaker:		4 Amp. Re-settable
Timer:		Electronic, w/hold or 0 to 99 minutes +/- 1%
Max. Power Requirements:		200 Watts
Voltage:		115 / 230 (+/- 10%) Volts
Frequency:		50/60 Hz

Why Horizontal Separation?

A horizontal rotor produces better separation with a tighter gel line, eliminating remixing and re-spins.

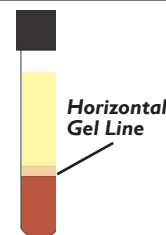

10mL test tubes up to 17mm x 100mm
UL Std. 61010A-1 and UL Std. 61010A-2-20, CAN/CSA C22.2 No. 1010.1 and CAN/CSA C22.2 No. 1010.2.20,
CE EN 61000-3-2, -3-3, EN 61000-4-2, -4-3, -4-4, -4-5, -4-6, -4-11, EN 61010-1, -2-020



The Horizon Model 842VES, Plasmafuge-6, is the most compact of Drucker's Performance Series centrifuges. The 842VES offers control over almost every aspect of the unit's operation from variable acceleration and deceleration to easy time and speed input. High speed and force capability produces platelet-poor/free plasma and greatly reduce processing times. The exclusive Drucker horizontal rotor allows for quick and easy sample loading and complete horizontal separation. Save settings in one of 10 memory locations and recall them at the touch of a button.

OPERATING FEATURES

- **ELECTRONIC TIMER w/DISPLAY:** Selectable from 1 to 99 minutes, hold feature, (+/-1%)
- **ELECTRONIC SPEED CONTROL w/DISPLAY:** Easily set the running speed by RPM or RCF
- **BRUSHLESS DC MOTOR:** For smooth and quiet operation with no routine maintenance
- **VARIABLE ACCELERATION AND DECELERATION:** Customize the run from start to finish
- **END-OF-RUN AUDIBLE INDICATOR:** Sounds when the rotor has stopped to inform the operator that a cycle is completed
- **VARIABLE SPEED:** Precision variable speed control gives the operator the ability to select from 500 RPM to the maximum rotor speed (see table) in 50 RPM increments
- **QUIET OPERATION WITH LOW VIBRATION:** Double-encased motor and Drucker's unique "stability mount" assure quiet performance and low out-of-balance vibration

SAFETY FEATURES

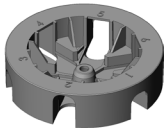
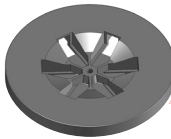
- **AUTOMATIC LID LOCK:** Centrifuge will not run with the lid open; lid cannot be opened while samples are spinning
- **POSITIVE LID LATCHING:** Firm mechanical latching of the lid prevents the escape of debris in case of breakage or an accident
- **OUT-OF-BALANCE DETECTION:** If an imbalance is detected, the centrifuge will come to a safe controlled stop
- **WELDED STEEL CONSTRUCTION:** For strength and durability
- **CLEAR LID:** Offers safe observation and access for phototachometer

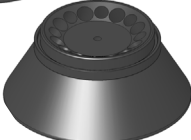
		PART NO.	# PLACES	MAX TUBE SIZE	SPEED RANGE	FORCE RANGE
	6-Place Horizontal (Standard)	7786022				
	75mm tube holders	7713043	6	17mm x 75mm	1000 to 4,500 RPM	140 to 2,260 xg
	100mm tube holders	7713040	6	17mm x 100mm	1000 to 4,500 RPM	140 to 2,800 xg
	6-Place Performance Plus Horizontal	7786017				
	75mm tube holder	7713056	6	13mm x 75mm	1000 to 6,500 RPM	140 to 5,000 xg
	12-Place Fixed-Angle STAT	7786003				
	75mm tube holder locations	n/a	6	15mm x 75mm	1000 to 7,000 RPM	140 to 4,880 xg
	100mm tube holder locations	n/a	6	15mm x 100mm	1000 to 7,000 RPM	140 to 5,700 xg
	12-Place Fixed-Angle STAT	7786001				
	75mm tube holder locations	n/a	12	15mm x 75mm	1000 to 7,000 RPM	140 to 4,880 xg

